

A truly long-lasting accurate CNC milling machine

CNC Milling Machine series

Patent
ZL 2006 20200398.4

Variable Speed Head
& Inverter Motor are available!!



Linear guideway patent design.



High and low voltage Electrical cabinet—Reduce interference & avoid components overheat.



Renishaw XL-80 laser measurement system.

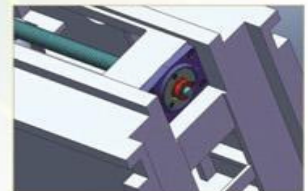

Pre-loaded X/Y-axis ballscrew.

310/520

GSK 928

KND 1000M



Innovative • Reliable • Practical

Imported Exclusively For:

CAN-DO
MACHINERY SALES

Machinery, Measurement Systems,
Tools & Accessories

Model			CNCM3	CNCM4	CNCM5	CNCM6
working Table	Dimensions	mm	254 × 1270 10" × 50"	254 × 1320 10" × 52"	280 × 1370 11" × 54"	306 × 1370 12" × 54"
	Max. Longitude Travel	mm	700 (27.56")	720 (28.35")	740 (29.13")	740 (29.13")
	Max. Cross Travel	mm	340 (13.39")	380 (14.96")	400 (15.75")	420 (16.54")
	Max. Knee Travel	mm	380 (14.96")	400 (15.75")	445 (17.52")	450 (17.72")
	Slot No. X Width	No.x mm	3 × 16 (5/8" × 3)			
	Pitch	mm	63 (2.48")		76 (2.99")	80 (3.15")
	Max. Load	Kg	300 (660 Lb)		400 (880 Lb)	500 (1,100 Lb)
Spindle	Max. Spindle Travel	mm	110 (4.33")		130 (5.12")	
	Spindle Taper Type		R8 (NT30 optional)		NT40	
	Range	rpm	70-4620		80-5440	
Feed Rate	Cutting Feed Rate	mm/min	0-2000 (0-78 in/min)			
	Rapid Feed Rate	mm/min	0-7500 (0-295 in/min)			
Main Motor	Voltage	V	220/380/415/440			
	Power	Hz	50/60			
	Power	Kw/HP	2.2/3		3.7/5	
X/Y Motor	Power	Kw	1.2 (1.64 Hp)			
	Torque	N.m	6 (53 Lb-In)			
Z Motor	Power	Kw	1.2 (1.64 Hp)			
	Torque	N.m	4 (35 Lb-In)			
Accuracy	Positioning	mm	0.015/300 (0.0006"/12")			
	Repeatability	mm	0.008 (0.0003")			
Other	Machine Dimensions(L × W × H)	m	1.8 × 1.6 × 2.1 71" × 63" × 83"	1.9 × 1.7 × 2.2 75" × 67" × 87"	1.9 × 1.8 × 2.3 75" × 71" × 91"	2 × 1.8 × 2.4 79" × 71" × 95"
	Net Weight	Kg	1400 (3000 Lb)	1600 (3520 Lb)	1700 (3740 Lb)	1850 (4070 Lb)



SP2008
All Right Reserved

P.O. Box 3071 - 9728 Variel Ave. - Chatsworth, CA 91311
Toll Free: (800) 532-2636 • Phone: (818) 727-0957 • Fax: (818) 727-1073
<http://www.candomachinery.com/Mills.html#jinpu>
sales@candomachinery.com